

PROJECT INFORMATION

Project Info	Date
<input type="text"/>	<input type="text"/>
Type	Quantity
<input type="text"/>	<input type="text"/>

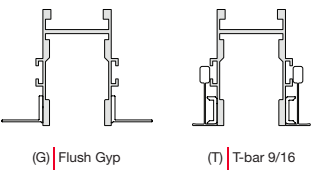
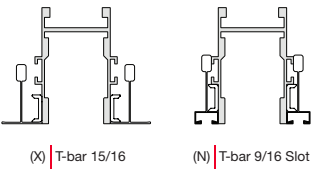

Need help?
Don't see what you need?
We know that having so many options can be overwhelming. Please reach out to our factory for any specific request or questions you have. Our talented Design Assist team is here to make the process move smoothly.

CUSTOM PATTERN ORDERING STEPS



OPEN PATTERN EXAMPLE:

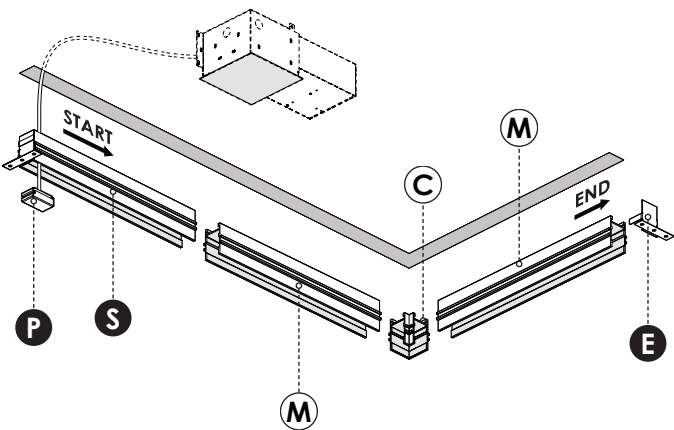

CLOSED PATTERN EXAMPLE:

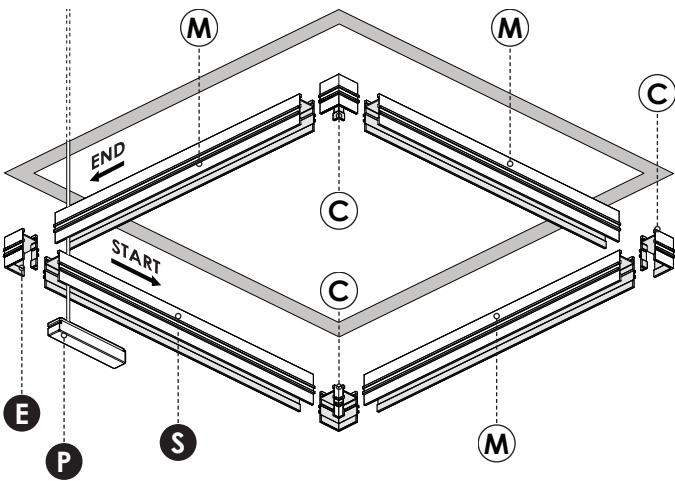

OPEN PATTERN ORDER SEQUENCE:

P + S + M + C + M + E

CLOSED PATTERN ORDER SEQUENCE:

P + S + C + M + C + M + C + M + E

The open shape pattern

An open shape pattern always starts with 'open start segment', followed by a succession of 'mid segments' and/or corners and finishes with an end cap.

The closed shape pattern

A closed shape pattern always starts with a 'closed start segment', followed by a succession of 'mid segments' and/or corners and finishes with a segment to match the 'closed start segment'.

S START SEGMENT

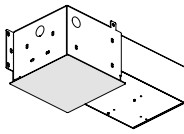

Recessed J-box
open pattern

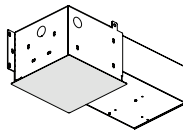

Recessed J-box
closed pattern

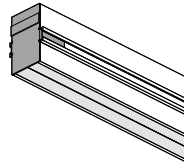

Integrated J-box
open pattern

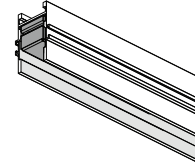

Integrated J-box
open pattern

ALG5S				
SERIES	POWER SOURCE	START SEGMENT	LENGTH	VOLTAGE
ALG5S	RJ Recessed J-box with cover plate IJ Profile integrated J-box	OR Open configuration start segment CR Closed configuration start segment	2 Nominal 2' 4 Nominal 4' 6 Nominal 6' 8 Nominal 8' M Exact Length*	U Universal 120V-277V

*Specify in inches to then nearest 1/8 (i.e. M180.125)

MOUNTING	FINISH	DIRECT DIMMING
G Gyp T T-bar 9/16" X T-bar 15/16" N T-bar 9/16" Slot	B Black	D 0-10V D4 Wireless Casambi NA nLight air NW nLight wired

Refer to the previous page to understand the order sequence differences between an open and closed pattern.

'Corner segments' must be separated by at least one 'mid segment'.

Standard 120-277V 100W (DC)

Recessed j-box: ø9.3" flat plate with recessed driver box. Standard white.

Recessed j-boxes are suitable for many kind of ceiling and leave more space for accessories in the track.

Integrated box is 8" long and occurs at every power drop. Only offered in black.

The integrated box makes it easier to install in the field and minimal intervention on the building the fixture is installed to.

MAGNETIC SYSTEM	LIGHT SOURCES DC LOAD									
ALG5	PACE (22°-55°)		PACE HE TECH		ALTA 45		ALTA 55		STRIDE (SQ-RN)	
	LH 17.0W	LS 10.0W	LH 13.0W	LS 7.0W	LH 13.5W	LS 6.5W	LH 18.5W	LS 10.5W	LH 11W/FT	LH 11W/FT

Here is how you determine if and when you need an extra power source :

If The total DC load (W) of installed light sources exceeds 100W, an additional power source must be added in a M 'mid segment'.

C CORNER

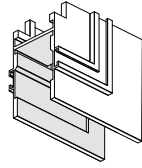

Vertical outside corner

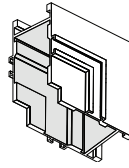

Vertical inside corner

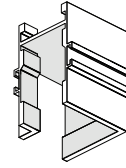

Horizontal flat corner

ALG5C			
SERIES	MID SEGMENT	MOUNTING	FINISH
ALG5C	OC Vertical outside corner	G Gyp	B Black
	IC Vertical inside corner	T T-bar 9/16"	
	FCR Horizontal flat corner right	X T-bar 15/16"	
	FCL Horizontal flat corner left	N T-bar 9/16" Slot	
	*Electrical connector provided with corner		

C 'corner segments' must be separated by at least one M 'mid segment'.

M MID SEGMENT

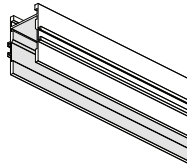

Mid segment no power

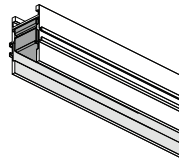
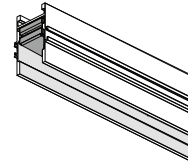

Powered recessed
J-box mid segment

Powered profile integrated
J-box mid segment

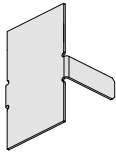
ALG5M						
SERIES	POWER SOURCE	LENGTH	VOLTAGE	MOUNTING	FINISH	DIRECT DIMMING
ALG5M	N No power	2 Nominal 2'	U Universal 120V-277V	G Gyp T T-bar 9/16" X T-bar 15/16" N T-bar 9/16" Slot	B Black	D 0-10V
	RJ Recessed J-box with cover plate	4 Nominal 4'				D4 Wireless Casambi
	IJ Profile integrated J-box	6 Nominal 6'				NA nLight air
		8 Nominal 8'				NW nLight wired
		M_ Exact Length*				
		*Specify in inches to then nearest 1/8 (i.e. M180.125)				

E END SEGMENT

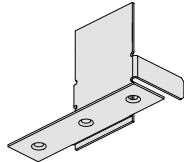

End cap T-bar mount

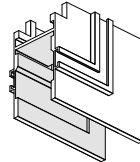
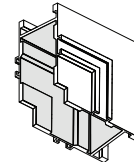
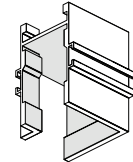

End cap gyp mount

Vertical outside
end corner

Vertical inside
end corner

Horizontal flat
end corner

ALG5E			
SERIES	JOINER / SWIVEL	MOUNTING	FINISH
ALG5E	CT End cap T-bar mount	G Gyp T T-bar 9/16" X T-bar 15/16" N T-bar 9/16" Slot	B Black
	CG End cap gyp mount		
	OC Vertical outside end corner		
	IC Vertical inside end corner		
	FCR Horizontal flat end corner right		
	FCL Horizontal flat end corner left		

To finish a closed pattern use the appropriate corner and for an open pattern use an end cap

Refer to page 16 to understand the order sequence of an open versus a closed pattern.

STANDARD ELEMENTS

Standard elements is a simplified product line comprised of 2', 4', 6' and 8' nominal length fixtures that can be joined to create continuous rows or patterns using other segments or corners.

NOMINAL LENGTH GYP

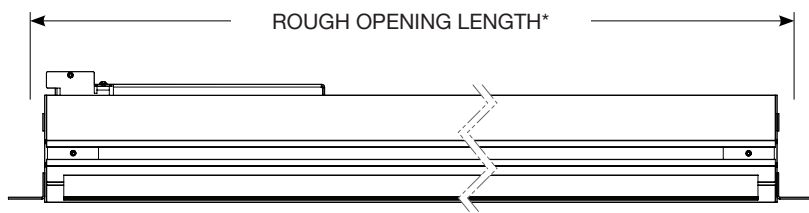

*For single segments only. For more dimensions go to the recessed opening dimensions.

NOMINAL LENGTH GRID CEILING

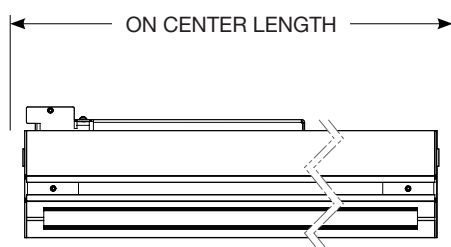

ON CENTER WIDTH	
T 9/16"x1/2"	2.35"
N 9/16" SLOT	2.35"
X 15/16"x1"	2.82"

ROUGH OPENING DIMENSIONS			
		LENGTH	WIDTH
NOMINAL 2'	ROUGH OPENING (GYP)	24.50"	2.75"
	ON CENTER (GRID)	24.50"	-
NOMINAL 4'	ROUGH OPENING (GYP)	48.50"	2.75"
	ON CENTER (GRID)	48.50"	-
NOMINAL 6'	ROUGH OPENING (GYP)	72.50"	2.75"
	ON CENTER (GRID)	72.50"	-
NOMINAL 8'	ROUGH OPENING (GYP)	96.50"	2.75"
	ON CENTER (GRID)	96.50"	-

For more information on mounting lengths, go to the recessed opening dimensions segment.

MAXIMUM MODULE QTY. PER POWER DROP

Maximum quantity of module per power drop are calculated by dividing the maximum DC load (100W) by the DC power consumption per module. For example, a maximum of 7 "ALIGN ALTA 45" at high output can be powered by a single power feed: $100W \div 13.23W = \approx 7$ units. A variety of different modules are available and combining several modules is possible and recommended.



Need several power drops for more modules or rows?
Have questions?
We know that having so many options can be overwhelming. Please reach out to our factory for any specific requests or questions you have. Our talented Design Assist team is here to help.

OUTPUT	MODULE	DC POWER	MAX QTY.
LH HIGH OUTPUT	PACE (22°-55°)	17.0 W	5
	PACE HE TECH	13.0 W	7
	ALTA 45	13.5 W	7
	ALTA 55	18.5 W	5
	STRIDE (RS - SQ)	11.0 W/ft	9 ft
LS STANDARD OUTPUT	PACE (22°-55°)	10.0 W	10
	PACE HE TECH	7.00 W	14
	ALTA 45	6.5 W	15
	ALTA 55	10.5 W	9
	STRIDE (RS - SQ)	-	-

COMPONENT DIMENSIONS

RECESSED J-BOX

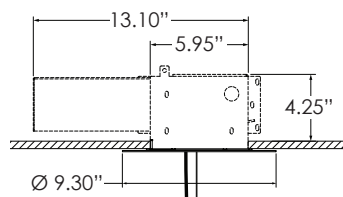

INTEGRATED J-BOX

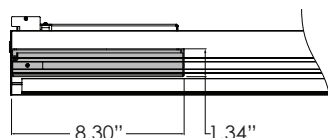

FLAT CORNER

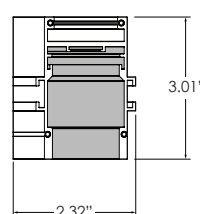

UP/DOWN CORNER

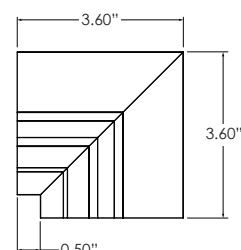

Recessed j-box depth: 5.95"

NOMINAL EXTRUSION DIMENSIONS	
	RECESSED GYP
NOMINAL 2'	24.00"
NOMINAL 4'	48.00"
NOMINAL 6'	72.00"
NOMINAL 8'	96.00"

Refer to recessed gyp
installation sheet to properly
install your patterns

Refer to shop drawings for exact
segment dimensions

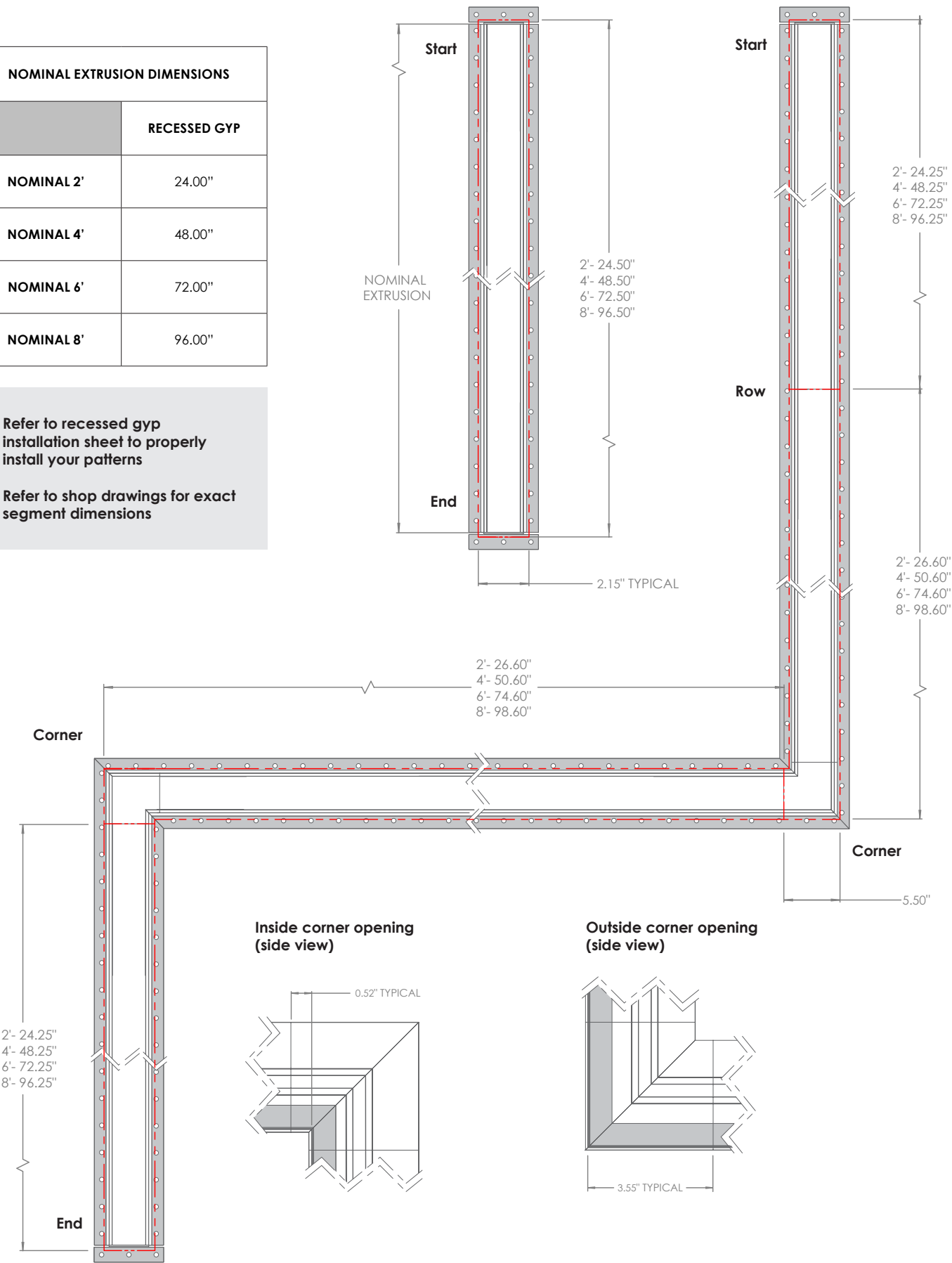

EXTRUSION DIMENSIONS	
	RECESSED T-BAR
NOMINAL 2'	24.00"
NOMINAL 4'	48.00"
NOMINAL 6'	72.00"
NOMINAL 8'	96.00"

TYPE OF T-BAR		
T	N	X
9/16"x1/2"	9/16" SLOT	15/16"x1"

Refer to recessed t-bar installation sheet to properly install your patterns

Refer to shop drawings for exact segment dimensions

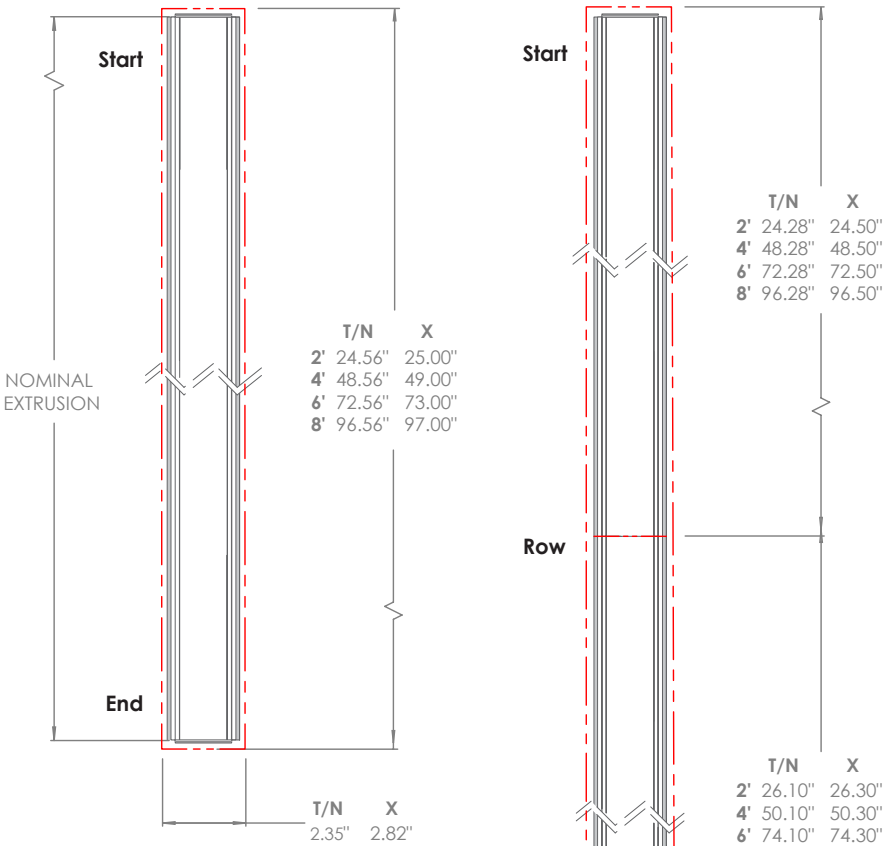

Corner

Corner

T/N	X
2'	24.28"
4'	48.28"
6'	72.28"
8'	96.28"

T/N	X
2.10"	2.30"

Inside corner opening (side view)

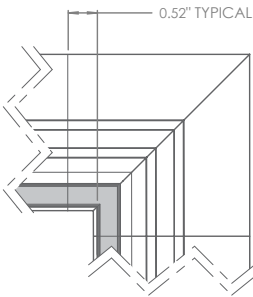

Outside corner opening (side view)

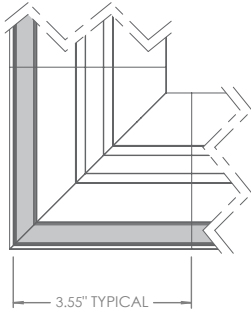

LINEAR DIMENSIONS

Align 2 - Nominal length available as individual fixtures or joined to create continuous row length, minimum fixture length is 12 inches.

Align 3 - Nominal length to the nearest inch available as individual fixtures or joined to create continuous row length, minimum fixture length is 12 inches.

Align 5 - Nominal length to the nearest inch available as individual fixtures or joined to create continuous row length, minimum fixture length is 12 inches.

Alta - Linear length of module is 6.50"

Pace - All pace modules are 12.40" long.

Stride - Stride is offered in 1', 2', 3' and 4' nominal length. Consult the factory for custom solutions.

OPTICS

Alta - Both Alta projectors offer 1 narrow and 1 wide beam angle.

Pace - Precise 0.5" baffled optics offer precise regressed lighting with a 22°,55° beam angle and A-light's proprietary HE Tech™ for a softer lambertian illumination.

Stride - Beautifully evenly diffused lens offered in 2 shapes, rounded and square, that can be dropped by half an inch on site without any tools.

Indirect - Diffuse dust cover for a wide lambertian distribution.

LED LIGHT SOURCE

All LEDs in this system are Nichia® LED combined with a performance driven heat sink technology. Tested in accordance with LM79 and LM-80; L70>60,000hr; operated at reduced output for high efficacy and lumen maintenance. 3000K, 3500K, and 4000K with 80+ CRI standard; other color temperatures and 90+ CRI available upon request, contact factory. LED color variation maintained at a 3-step MacAdam ellipse (SDCM 3x). LEDs are available in Standard, and High outputs. Refer to photometry for delivered lumens.

LED DRIVER

Standard 48V constant voltage universal 120-277V electronic driver provide power to DC to DC drivers that control the individual light sources Max Driver life of 50,000 hrs with ambient operating temperature range of -20°C to 70°C, maximum case temperature of 90°C. Electrical specifications at maximum driver load: PF >0.90, THD <2.0%, 92% Efficiency.

DIMMING CONTROLS

0-10V - The DC to DC drivers in each direct modules and indirect segment provide standard 0-10V dimming. Each Direct module can be individually tuned to set max output using graded potentiometer on top of fixtures.

Wireless Casambi - Each module and indirect segment can be ordered Casambi ready. Any bluetooth enabled iOS or Android smartphone with the free Casambi app can control the dimming of one or multiple light sources wirelessly.

nLight® AIR - A simplified wireless lighting control solution that give users the ability to regulate devices on any handheld device. Using the CLARITY APP, you can pair and group devices as well as customize sensor settings.

nLight® WIRED - A collection of lighting control solutions that function wired together to adapt to a space's lighting. With a collection of sensors and switches it is possible to adapt fixtures to any environment

EMERGENCY

This luminaire is provided with a LED emergency lighting battery pack for both normal and emergency operation, 120-277v only. This emergency pack contains long-life Ni-Cad recyclable battery, 24 hour charger, and converter circuit. Test switch and charge indicator provided. Test button to be remote located within 3 feet of the luminaire, by others in accordance with local code. Emergency mode provides constant power to a nominal 10W LED load for a period of 90 minutes. Please consult the factory for emergency configuration assistance. Our talented Design Assist team is always available for collaboration and specification support. Only segments with integral drivers can be emergency wired.

MOUNTING

For T-bar - rest lower fixture flange on top side of t-bar ceiling system and secure to structure with tie wires.

Gyp - lower fixture flange is attached to gyp ceiling and blocking (by others), then mudded over and/or painted by installing contractor.

Pendant - Suspension with aircraft cables. Aircraft cable set includes 48" standard length 1/16" stainless steel adjustable aircraft cables with secure micro grippers to field set suspension length, comes factory installed in fixture. 4-1/2" x 4-1/2" square white canopies. Cord strain also included.

Surface - Die-cast mounting blocks are used to provide a firm and flexible mounting option in any orientation the system might be installed in.

STRUCTURE

Robust, high quality 60% recycled aluminum extruded housing. 0.040" thick aluminum internal gear trays. Flat or flanged aluminum end caps. Aluminum joiner brackets. 4 lbs/ft approximate fixture weight.

FINISH

Electrostatically applied powder coat finish. Standard finish options include white and black. Other colors and custom finish options available, specify RAL# or contact factory regarding custom finish requirement.

LISTING

UL/CUL rated for Damp Locations. Tested in accordance with UL 1598 and certified to CEC/CSA C22.1, NEC, ANSI/NFPA 70, and NOM-001-SEDE.

WARRANTY

Limited defect-free manufactured equipment warranty provided under normal use and proper storage for a period of one (1) year. LED products (LED boards and drivers) will be covered for a period of five (5) years. Please refer to full terms and conditions on our website.